

DM4 Direct Control Chain Hoist Controller

The DM4 chain hoist controller, one of our range of control system 'building blocks', is designed to withstand the rigours of touring and staging life. The DM4 is housed in a steel rack mount case, and with features such as selectable input voltage is ideally suited to use throughout the world.



- ◆ Four channels of direct hoist control using reversing contactors
- ◆ Industry standard Cee-type output connectors
- ◆ Input voltage selection switch - the DM4 can be used worldwide
- ◆ Input voltage phase indicators and reversal switch
- ◆ Optional HC4 Handcontroller for remote pendant control
- ◆ Optional remote GO button, link-able across multiple units
- ◆ Optional remote Emergency Stop button, link-able across multiple units
- ◆ Fully compliant with CE directives

o u t b o a r d



DM4 Operation and Technical Details

The DM4 is designed to operate four direct control chain hoist motors in staging and rigging applications with internal contactors to provide direction control by switching phase rotation. It features heavy duty connectors and controls and is housed in a compact 3U high 19" rack mount case making it ideal for touring and fixed applications. The DM4 fully conforms to European EMC and LVD requirements.

An input MCB provides overall system on / off control and protection against output overload faults. The MCB is rated at 20A with D characteristic providing 10 - 20 times normal rating for start up surges.

Phase direction and power on indicators show incoming mains status. The phase reversal switch should be set so the green neon is lit to ensure that the motors run in the correct direction.

Local control switches allow the DM4 to be programmed from the front panel. Only a local Go or Remote Go or Go Link will activate hoists to this program. An alternate program can be set on the HC4 hand controller and activated from the hand controller Go. Program switches are protected by a crash bar and direction is indicated by green and red LEDs.

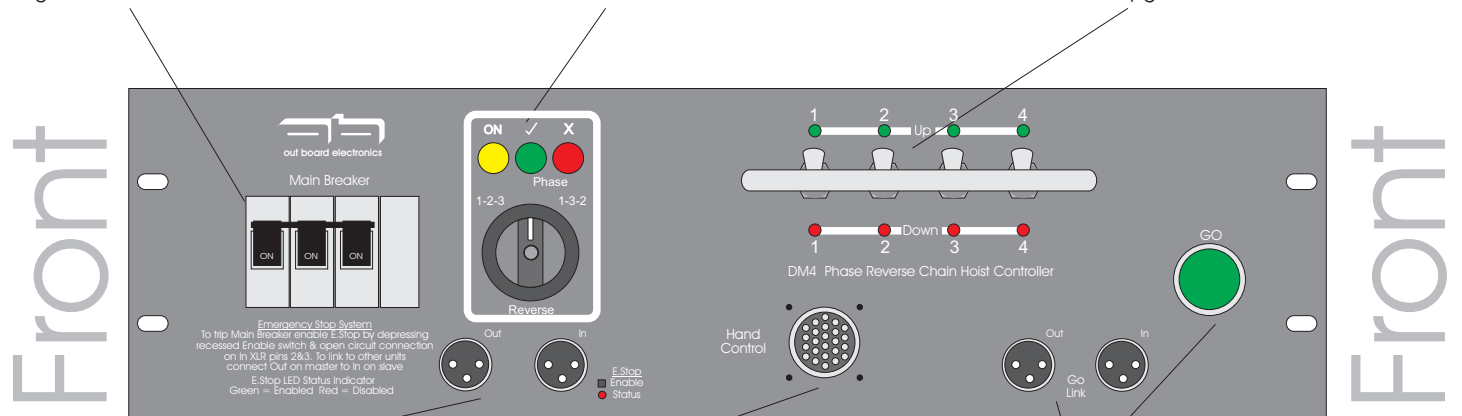

The Emergency Stop feature allows the DM4 to be shut off from a remote push-to-break emergency stop button connected between pins 2 & 3 on the female XLR. A recessed push button switch can be activated to disable the feature. An LED indicates green when the Emergency Stop feature is enabled, and red when it is disabled. Ask us about the optional Out Board remote E-Stop button.

Complete independent remote operation of the DM4 is possible using an optional hand control facility. The optional HC4 Handcontrol unit allows control of motor direction programming and Go. The handheld HC4 is housed in a rigid steel enclosure and is connected to the DM4 via a multicore cable.

Once programmed on the local switches, motors may be activated using the front panel Go switch or by using the Go Link facility. The Go Link feature allows the DM4 to be controlled from a roving Go button as well as allowing any number of DM4's to be controlled from a single Go command. To initiate a remote Go, pins 2 & 3 are shorted together on the 'Go Link In'. This causes an internal relay to link pins 2 & 3 on the 'Go Link Out' for daisy chaining to the next unit. To connect several units together, standard 3 pin XLR cables are used to link the 'Go Link Out' of the first DM4 to the 'Go Link In' of the next, and so on. The local Go on the first unit will now control the others, as will a roving go connected to the Go Link In on the first unit. Ask us about the optional Out Board handheld Remote GO switch.

out board

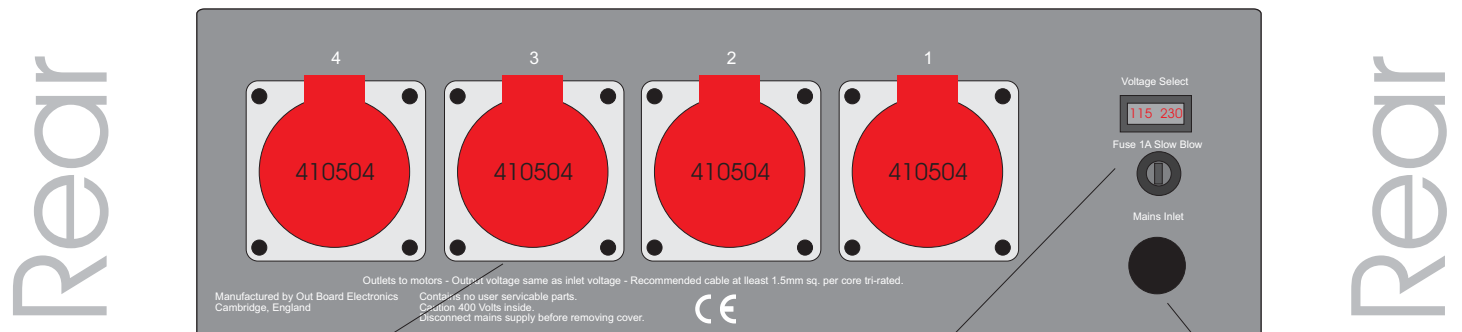

Connection to each motor consists of 3 phase power and earth on a 16A 4 pole red ceetype socket.

Selectable mains voltage between 115V and 230V enables operation of the controller anywhere in the world. Note, motors must be re-tapped for operation at different voltages.

Mains power inlet on a 5 pole 32A ceetype line plug carrying 3 phase N + E

Dimensions: H: 3U (13.34cm) x W: 19" (48.26cm) x D: 31cm. Allow 10cm for rear chassis connectors and inlet cable bend radius. Shipping Weight: 20kg

Designed and manufactured by:

Out Board Electronics, Mills & Douglas Building, Barrington Road, Orwell, Cambs, SG8 5QP, England.

tel: +44 (0)1223 208183

fax: +44 (0)1223 208190

www.outboard.co.uk